

Aspira[®] -aXA



Technical Information

● Foldable Monobloc Posterior Chamber Lens

● Material:

- Hydrophilic MicroCryl[®]
- UV inhibitor

● Optic:

- Aberration correcting (aspheric posterior surface)
- Sharp optic edge

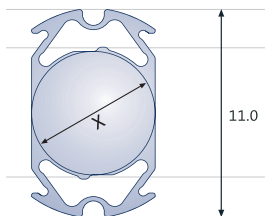

Optic diameter depending on IOL power (5.5 mm – 7.0 mm)

in mm

● Est. A-Constant: 118.3*

(*for current status please refer to www.humanoptics.com)

Diopter Range

biconvex

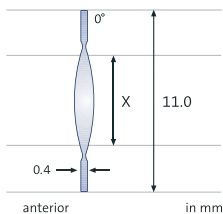

In 0.5 D steps

10.0 D to 13.0 D

13.5 D to 30.0 D

In 1.0 D steps

-6.0 D to 9.0 D

31.0 D to 40.0 D

concave/convex

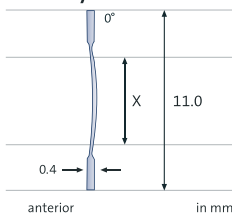

Indication Recommendations



- ✓ Cataract
- + Extreme Hyperopia
- + Extreme Myopia
- + Improved Functional Vision
- + Reduced Glare Sensitivity

Manufactured by

HumanOptics AG
Spardorfer Str. 150
91054 Erlangen · Germany
Tel: + 49 91 31/50 66 5.0
Fax: + 49 91 31/50 66 5.90
mail@humanoptics.com
www.humanoptics.com

Distributed by